

DB32 Pontechtron  
Overall Length 9.570m  
Overall Width 2.200m  
Overall Body Height 4.371m  
Min Body Ground Clearance 0.483m  
Max Track Width 2.302m  
Lock to lock time 6.00s  
Kerb to Kerb Turning Radius 10.450m

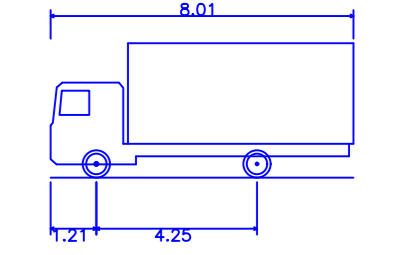

7.5t Box Van  
Overall Length 8.010m  
Overall Width 2.450m  
Overall Body Height 4.350m  
Min Body Ground Clearance 2.064m  
Track Width 4.900m  
Lock to lock time 7.400m  
Kerb to Kerb Turning Radius 7.400m

- KEY
- EXISTING LINE MARKING TO BE RETAINED
  - EXISTING SIGN POST/LIGHTING COLUMN TO BE RETAINED. ANY EXISTING SIGNS TO BE REMOVED. NEW SIGNS TO BE PROVIDED. SEE DETAILS BELOW
  - PROPOSED SIGN POST
  - BELISHA BEACON

- TAKE OFF
- 38No. 1.8m x 0.9m BRL PLANTERS
  - 247m THERMOPLASTIC DOUBLE YELLOW LINING
  - 106m THERMOPLASTIC SINGLE YELLOW LINING
  - 10m ONE WAY LINE MARKING
  - 4No. 76mm DIA GALVANISED ALUMINIUM SIGN POSTS 3.6m LENGTH
  - 2No. NAL SOCKET FOR POST IN BLOCK PAVING
  - 2No. REFLECTORISED 750mm DIA 615 SIGN
  - 2No. REFLECTORISED PLATE 'ONE WAY TO ONCOMING VEHICLES' SIGN
  - 2No. REFLECTORISED 525mm x 600mm 811a SIGN
  - 2No. REFLECTORISED PLATE 'PRIORITY OVER ONCOMING VEHICLES' SIGN
  - 5No. PARKING ENFORCEMENT SIGNS (DETAILS TBC)
  - 232.4m<sup>2</sup> RED TACTILE PAVING FOR ZEBRA CROSSING TO BE PROVIDED
  - 66m<sup>2</sup> PRIMER AND SPRAY ON SOLID WHITE LINING TO DENOTE PARKING BAY
  - 2No. ZEBRA CROSSING LINING WITH SPRAY ON WHITE ZEBRA MARKINGS EACH 0.6m x 3.0m ON BLOCK PAVING
  - 204m<sup>2</sup> ZIG ZAG LINING FOR ZEBRA CROSSING - HALF WITH PRIMER AND SPRAY ON WHITE LINING, HALF WITH THERMOPLASTIC WHITE LINING
  - 44No. ZEBRA CROSSING WHITE SPRAY ON DOTS (IN PLACE OF ROAD STUDS), 0.1m x 0.1m AT 0.5m CENTRES
  - 25m ZEBRA CROSSING ONE WAY LINING
  - 4No. SOLAR POWERED BELISHA BEACONS
  - 2No. 6.0m LENGTH TSDQ DIA 1014 DEFLECTION LEFT ARROWS
  - 1No. PARKLET ARRANGEMENT

- 2No. BUS CAGE LINE MARKINGS TO BE REMOVED (13.0m x 3.0m)
- 13.0m ONE WAY LINE MARKINGS TO BE REMOVED
- 3.0m CENTRE LINE MARKINGS TO BE REMOVED
- 4No. 616 NO ENTRY SIGNAGE TO BE REMOVED
- 4No. 'EXCEPT BUSES' SIGNAGE TO BE REMOVED
- 48m<sup>2</sup> RED SURFACING TO BE REMOVED
- 10m<sup>2</sup> OF EXISTING TACTILE PAVING TO BE REMOVED AT PROPOSED ZEBRA CROSSING
- 23m<sup>2</sup> OF EXISTING BLOCK PAVING TO BE REMOVED AT PROPOSED ZEBRA CROSSING

REV	DATE	BY	DESCRIPTION	CHK	APP
REV	09/07/2023	SDC	PLANTER NUMBERS INCREASED, BAY LENGTH REDUCED	LAM	LAM
REV	09/07/2023	SDC	FIRST ISSUE	LAM	LAM

FOR INFORMATION ONLY

**wsp**

Unit 9 The Chase, John Tate Road, Fobotes Business Park, Hertford, SG13 7JN, UK  
T: +44 (0) 1992 520 000, F: +44 (0) 1992 520 001  
wsp.com

**BARKING RIVERSIDE**

PROJECT: BARKING RIVERSIDE LONDON

TITLE: HANDLEY PAGE ROAD PARKING OPTION 3

SCALE: 1:250

CHECKED: LAM APPROVED: LAM

PROJECT NO: 70018976 DESIGNER: SDC DATE: July 23

DRAWING NO: BRL-WSP-ZZZ-XX-XX-SK-D-8219 REV: P02

© WSP UK Ltd

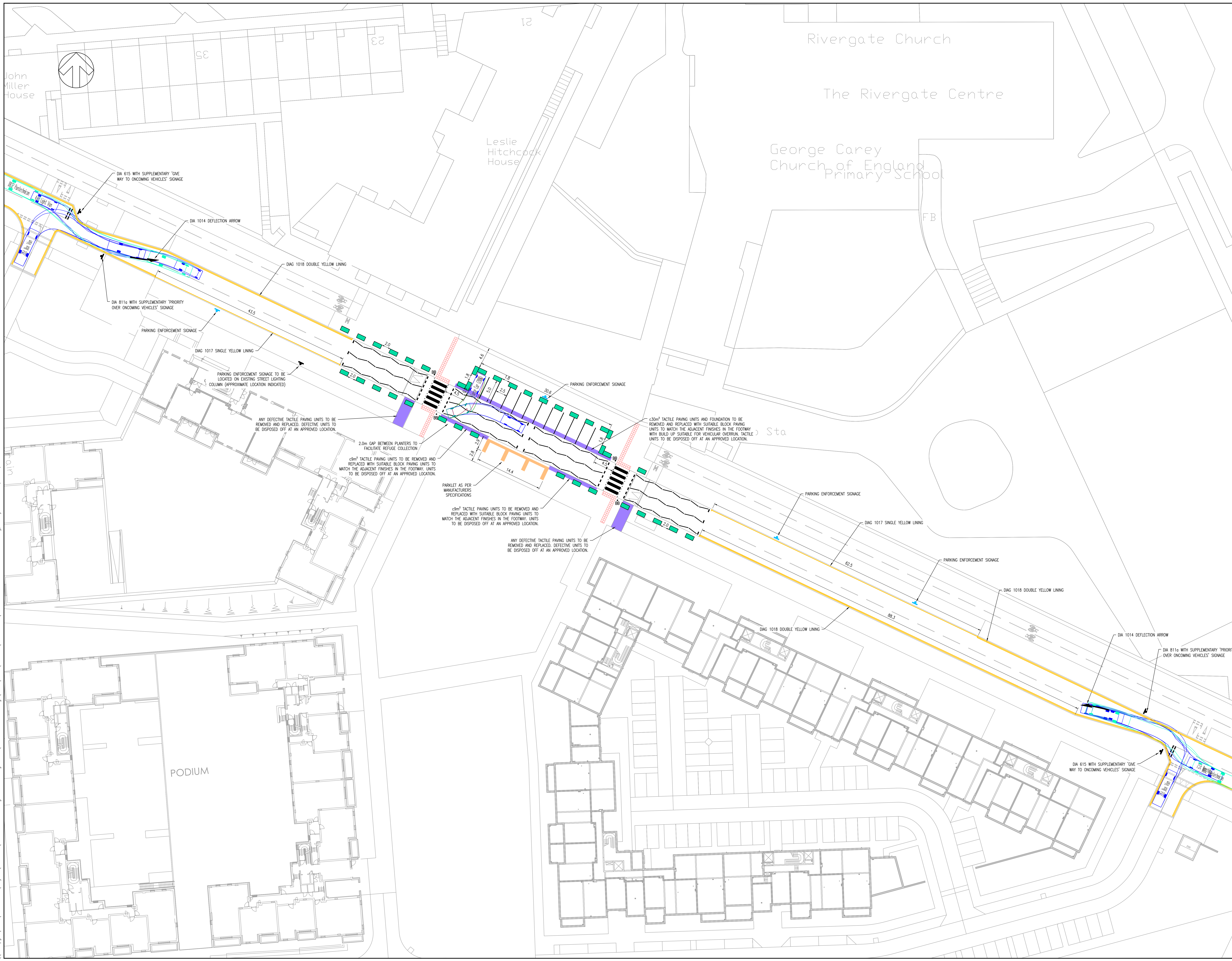

\\uk.wspgroup.com\central\_data\Projects\70018976\70018976 - Barking Riverside and Drawings\Development\AUTOCAD\SK\_Sketches\BRL-WSP-ZZZ-XX-XX-SK-D-8219.dwg, 10 July 2023 11:40, Curtis, Sam